

Schüco ASE 70 PD.ME

Aluminium Panorama Design Sliding System



Schüco ASE 70 PD.ME benefits



External views of
Schüco ASE 70 PD.ME
double sliding doors

Thanks to the high stability of aluminium, Schüco ASE 70 PD.ME sliding systems can be designed with narrow profiles and particularly large areas of glass, providing maximum transparency and light penetration.



The Schüco ASE 70 PD.ME sliding system is a high-quality system with a high degree of flexibility to meet customers requirements in functionality but also design. The excellent performance to investment ratio, the large possible vent dimensions and the last but not least robust fitting range for a long term and reliable performance makes the system a great choice.

A construction designed for the minimal tool usage and the simplest possible production guarantees excellent fabrication quality.

The Schüco ASE 70 PD.ME has been tested in accordance with project-specific requirements as per the European Standards in recognised test institutes. The diversity of requirements and unit sizes produces a large number of different test results. Every new project must be considered on an individual basis and the requirements must be stipulated individually.



Wide range for maximum transparency

 Product benefits	 Fabrication benefits
<ul style="list-style-type: none"> ▪ Thermally insulated ▪ The right U-value for the middle east climate ▪ Maximum comfort with manual operation ▪ Absolutely unrestricted access ▪ Maximum unit widths for maximum transparency ▪ Extended range for even more flexibility ▪ Up to 6 leaf units possible ▪ Narrow face width of 39 mm in the interlock section ▪ Multiple different opening types ▪ 2 threshold options ▪ Vent load up to 400 kg ▪ Glass thickness from 24 mm up to 40 mm 	<ul style="list-style-type: none"> ▪ Retaining catch integrated into the guide rail system ▪ New innovative guide rail system ▪ Door heights up to 3500 mm (increased heights to be determined on project basis) ▪ Simple butt joint fabrication ▪ Air permeability up to class 4 in accordance with EN 12207 ▪ Water tightness up to class 8A in accordance with EN 12208 ▪ Wind load resistance up to class C5 in accordance with EN 12210

Overview of opening types

Type 2A

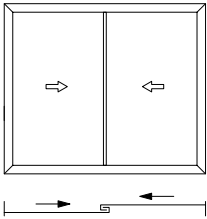

Type 2A/1

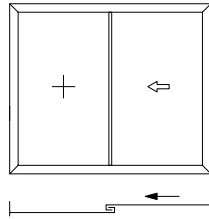

Type 2B

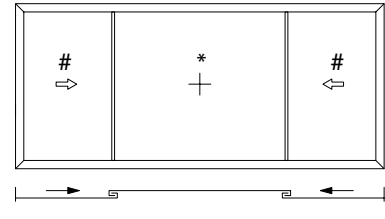

Type 2C

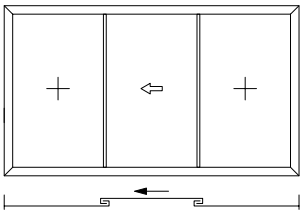

Type 2D

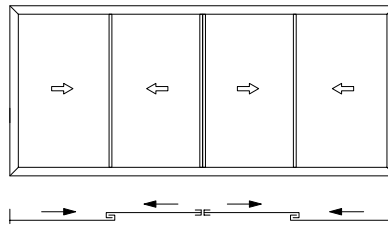

Type 2D/1

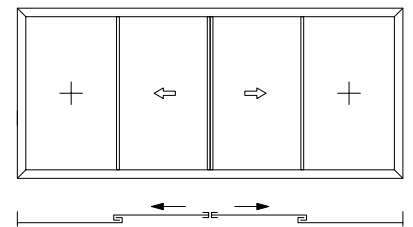

Type 3E/1

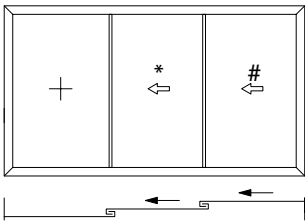

Type 3F

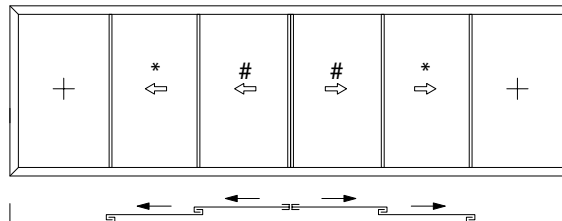

Integrated curtain wall

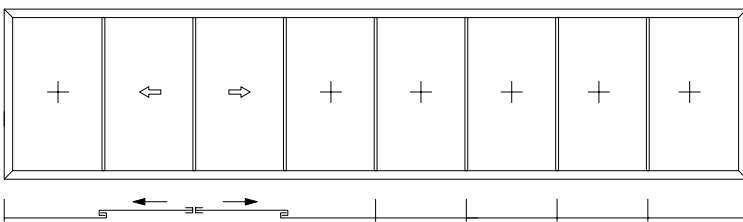

Type Pivot

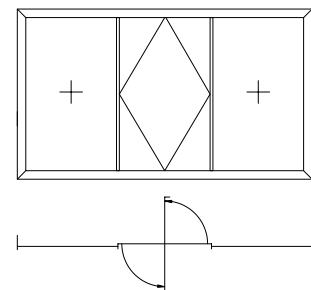

Type 2D - 90° corner

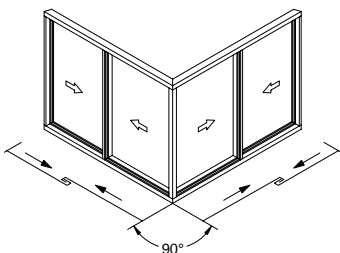

Type 2D/1 - 90° corner

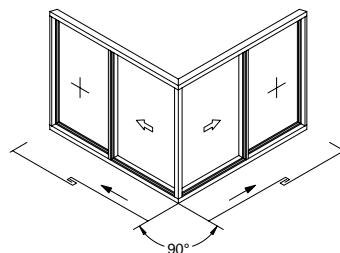

Type 3F - 90° corner

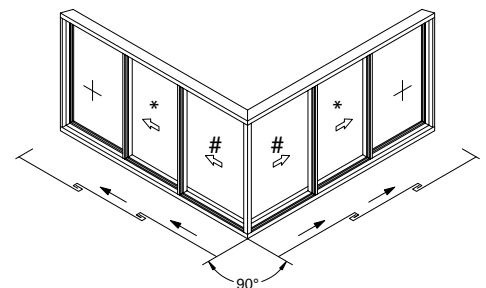

Type 2B, 3E, 3F: Vents marked with * must be at least 100 mm wider than vents marked with #

Type 3F 90°-corner: Vents marked with * must be at least 200 mm wider than vents marked with #

Section details

Type 2A/1 - Double track

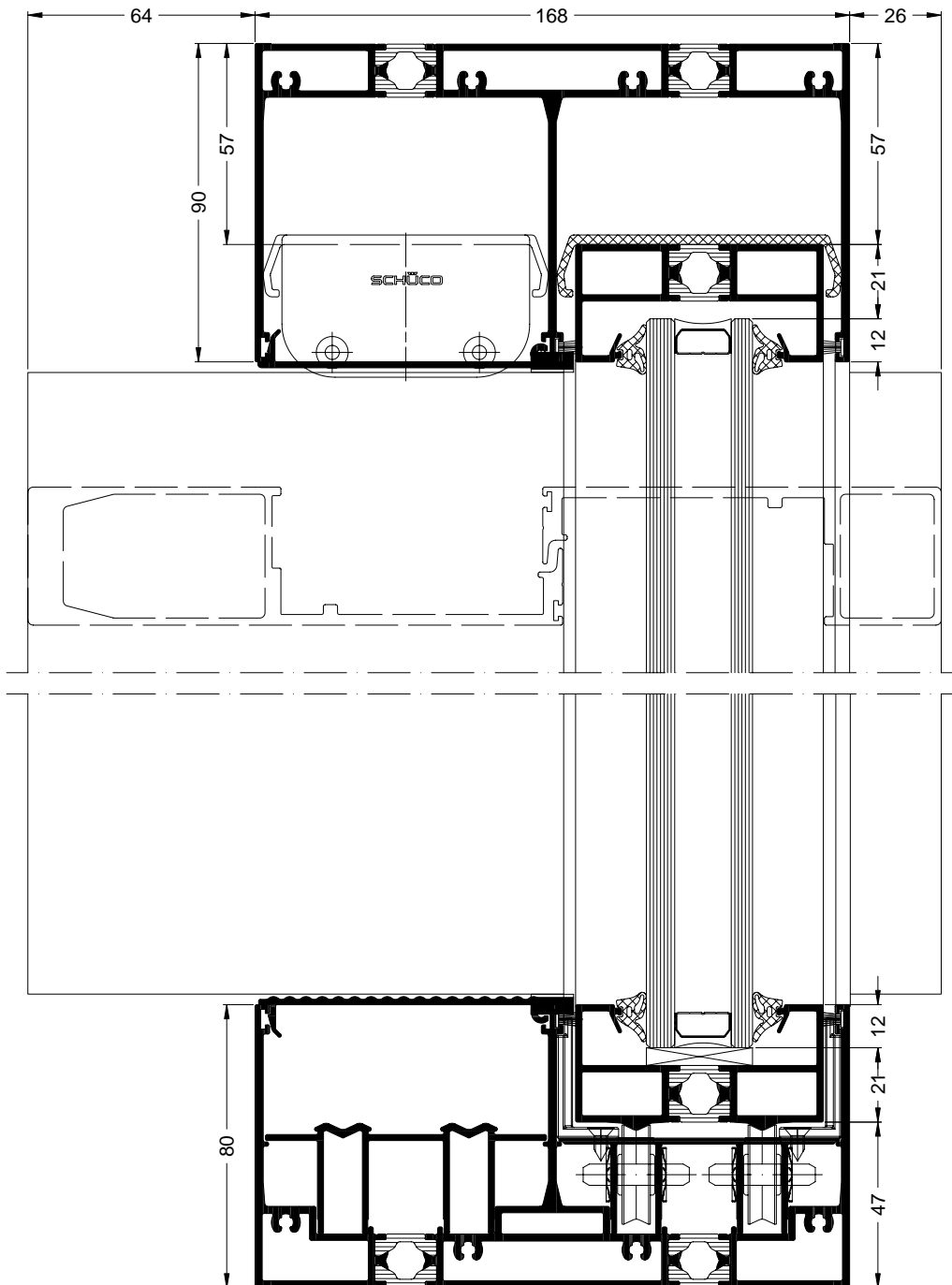
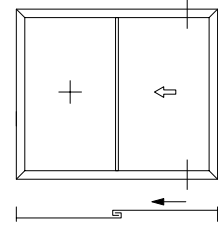

Type 3E/1 - Triple track

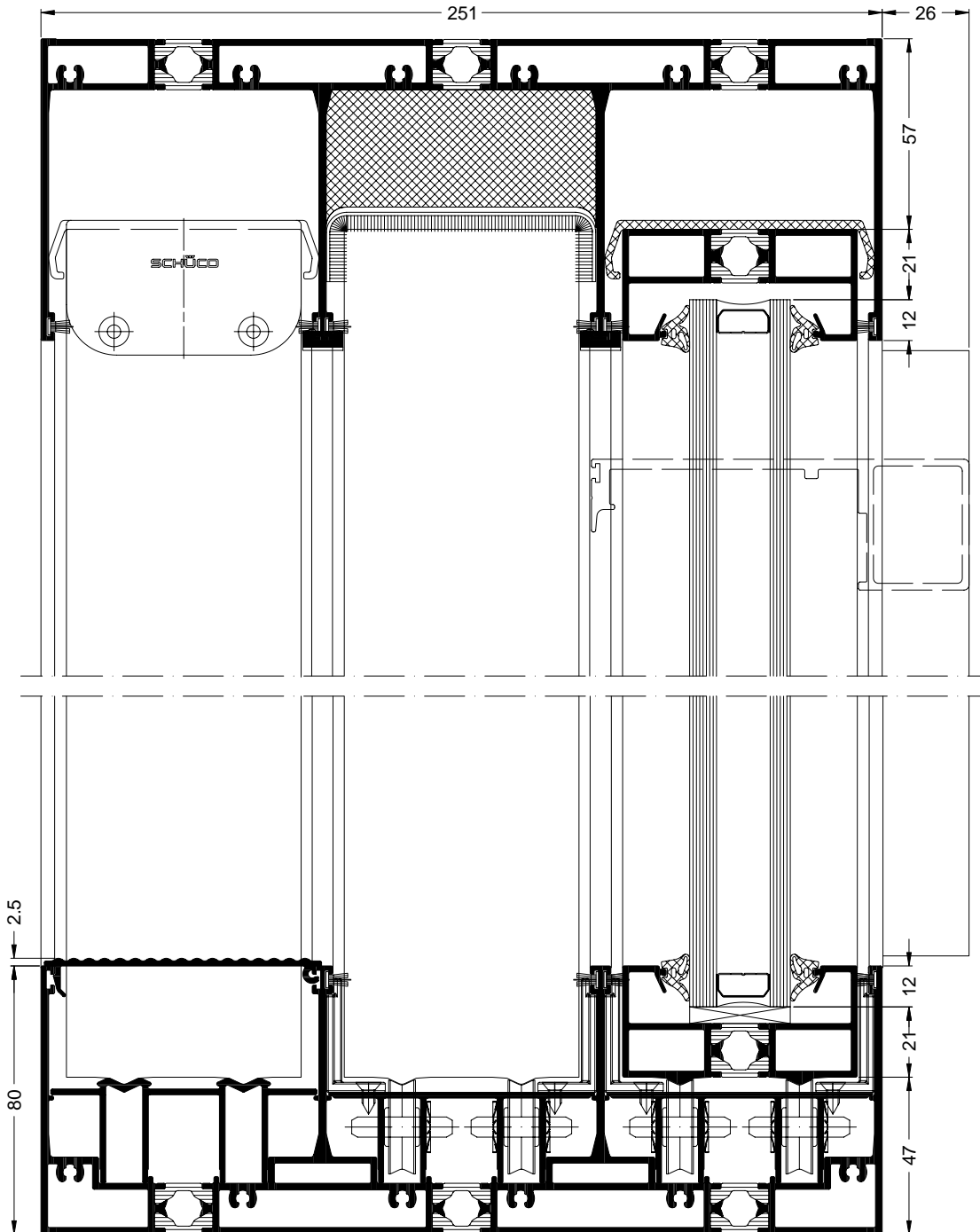
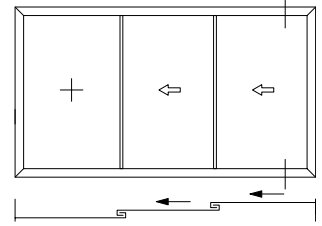

Type 2A/1 - Double track - 90° corner

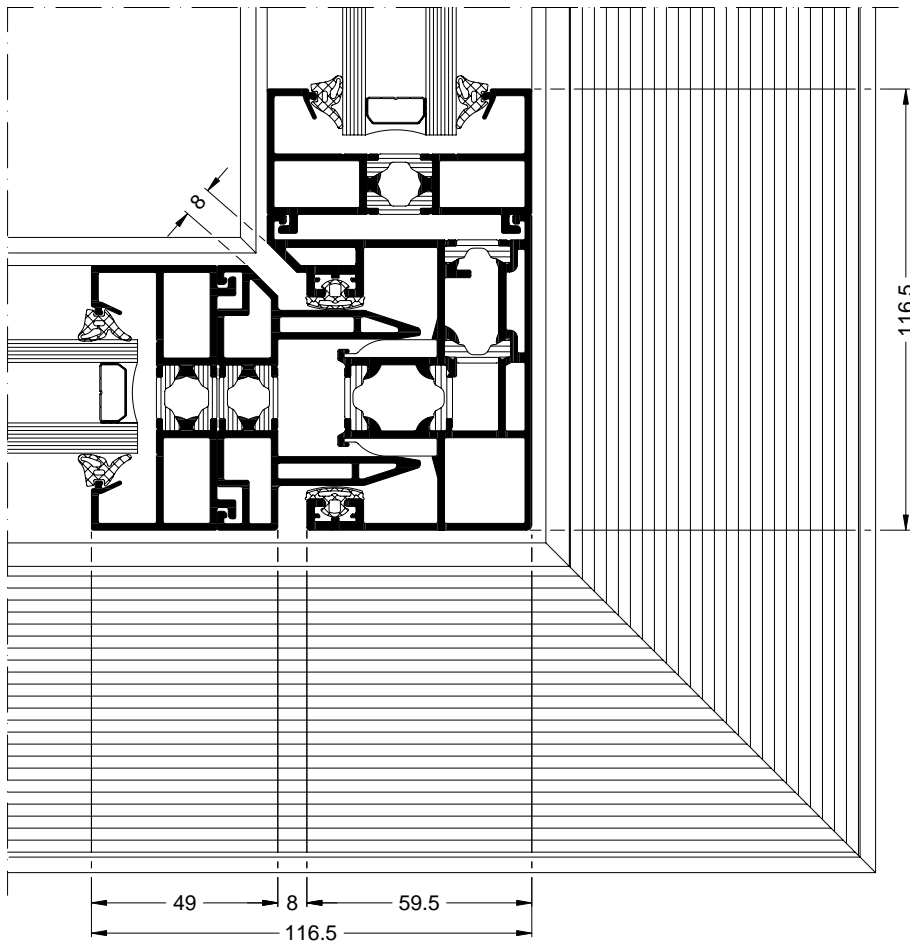
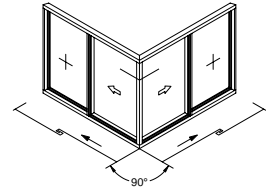



Schüco International KG

www.schueco.com

Schüco – System solutions for windows, doors and façades

Based in Bielefeld, Schüco International KG develops and sells system solutions for windows, doors and façades. With more than 4750 employees worldwide, the company strives to be the industry leader in terms of service and technology today and in the future. In addition to environmentally friendly products for residential and commercial buildings, the building envelope specialist offers consultation and digital solutions for all phases of a building project – from the initial idea through to design, fabrication and installation. 12,000 fabricators, developers, architects and investors around the world work together with Schüco. The company is active in more than 80 countries and achieved a turnover of 1.460 billion euros in 2016.

SCHÜCO