

**WICONA®**

By  Hydro



© Fotograf Felix Gerlach

Aluminium solutions for façades,  
windows, doors and sliding elements

**WICTEC 50SG**

» Structural glazing curtain wall

ALUMINIUM PROFILE SYSTEMS

# » WICTEC 50SG Structural glazing curtain wall



A characteristic feature of WICTEC 50SG structural glazing curtain wall is the flush design with slim silicone joints between the glass panes. The system offers all-glass technology both for vertical curtain walls and sloped roof glazing. Based on the standard WICTEC 50 stick system these options can be realised with simplified and economic processing and assembly, while assuring a high level of quality.

The WICLINE 90SG integrated opening sash complements the homogeneous full glass design with Italian style or parallel outward opening functionality.

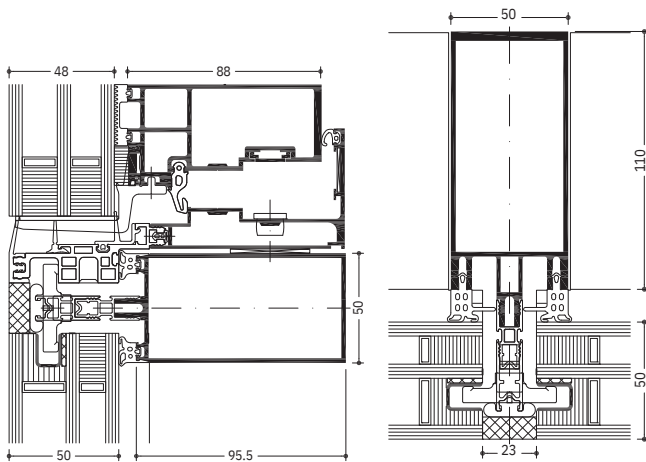

WICTEC 50SG with integration sash WICLINE 90SG

WICTEC 50SG

### System test results / CE product pass in accordance with DIN EN 13830

Air permeability: Class AE	
Water tightness: RE 750	
Resistance to wind load: 2000 Pa, security $\pm$ 3000 Pa	
Impact resistance: Class E5 / I5	
Approval: ETA: 12/0551	(European Technical Approval)
Quality assurance: Certified according to ISO 9001:2008	
Environmental management: Certified according to ISO 14001	

### Technical performance:

System width: Internal aluminium profiles 50 mm  
 External silicone joint 23 mm  
 Thermal insulation: U  
 f up to 1.6 W/(m<sup>2</sup>K)  
 Infill thickness: up to 64 mm

### System technology:

ETA (European Technical Approval) granted Outstanding appearance  
 Basic structure same as the WICTEC 50 curtain wall, with identical profile and gasket technology  
 Fast and simple installation of IGUs, thanks to a special patented fastener  
 Can also be combined with external cover profiles in various shapes and designs  
 The ideal complement: WICLINE 90SG all-glass integrated sash with Italian style or parallel outward opening functionality



Austria  
5201 Seekirchen  
☎ +43 6212 2000  
✉ info@wicona.at

Benelux  
3400 Landen  
☎ +32 11 690316  
✉ info@wicona.be  
✉ info@wicona.nl

Croatia  
10010 Zagreb  
☎ +385 01 2048 217  
✉ info@wicona.de

Czech Republic  
619 00 Brno  
☎ +420 602 745 407  
✉ wicona@wicona.cz

Denmark  
8240 Risskov  
☎ +45 7020 2048  
✉ wicona@wicona.dk

España  
08195 Sant Cugat del Vallès  
Barcelona  
☎ +34 93 573 77 76  
✉ wicona.es@wicona.com

Estonia / Latvia  
75312 Rae vald Harjumaa  
☎ +372 657 66 35  
✉ info@wicona.ee

France  
02200 Courmelles  
☎ +33 3 23598200  
✉ info@wicona.fr

Germany  
89077 Ulm  
☎ +49 731 3984-0  
✉ info@wicona.de

Hungary  
1031 Budapest  
☎ +36 (1) 4533457  
✉ info@wicona.hu

Ireland  
Dublin D22 X286  
☎ +353 1 4105766  
✉ info@wicona.ie

Italia  
20063 Cernusco sul Naviglio MI  
☎ +39 02 924291  
✉ info@wicona.it

Kosovo-Albania  
Prishtina 10000, Kosovo  
☎ +38 349 28 02 22  
✉ info@wicona.de

Lithuania / Latvia  
02244 Vilnius  
☎ +370 5 2102587  
✉ info@wicona.lt

Norway  
2007 Kjeller  
☎ +47 22 42 22 00  
✉ wicona@wicona.no

Poland  
93-428 Łódź  
☎ +48 42 683 63 73  
✉ wicona.pl@hydro.com

Romania  
032332 Bucharest  
☎ +40 724 743 070  
✉ info@wicona.de

Serbia  
11070 Beograd  
☎ +381 11 312 18 35  
✉ info@wicona.de

Slovakia  
82105 Bratislava  
☎ +421 918 725 098  
✉ info@wicona.sk

Slovenia  
2201 Zg. Kungota  
☎ +386 2 620 99 70  
✉ info@wicona.de

Sweden  
574 81 Vetlanda  
☎ +46 470 78 74 00  
✉ wicona@wicona.se

Switzerland  
5506 Mägenwil  
☎ +41 62 887 41 41  
✉ info@wicona.ch

United Kingdom  
Tewkesbury, GL20 8SF  
☎ +44 1684 853500  
✉ info.wiconauk@wicona.com

China  
Beijing 100005, P.R.C  
☎ +86 10 6059 5686 ext. 805  
✉ contact.wicona.international@wicona.com

Singapore  
608831 Singapore  
☎ +65 6513 2126  
✉ contact.wicona.international@wicona.com

United Arab  
Emirates Dubai  
☎ +971 4 887 00 96  
✉ contact.wicona.international@wicona.com

United States of America  
☎ 1+(516) 519-4635  
✉ info.na@wicona.com

Other countries  
31037 Toulouse  
☎ +33 5 61312626  
✉ contact.wicona.international@wicona.com